

Cartagena International ARCHITECTURE Workshop

OVER THE WALL

Group 5

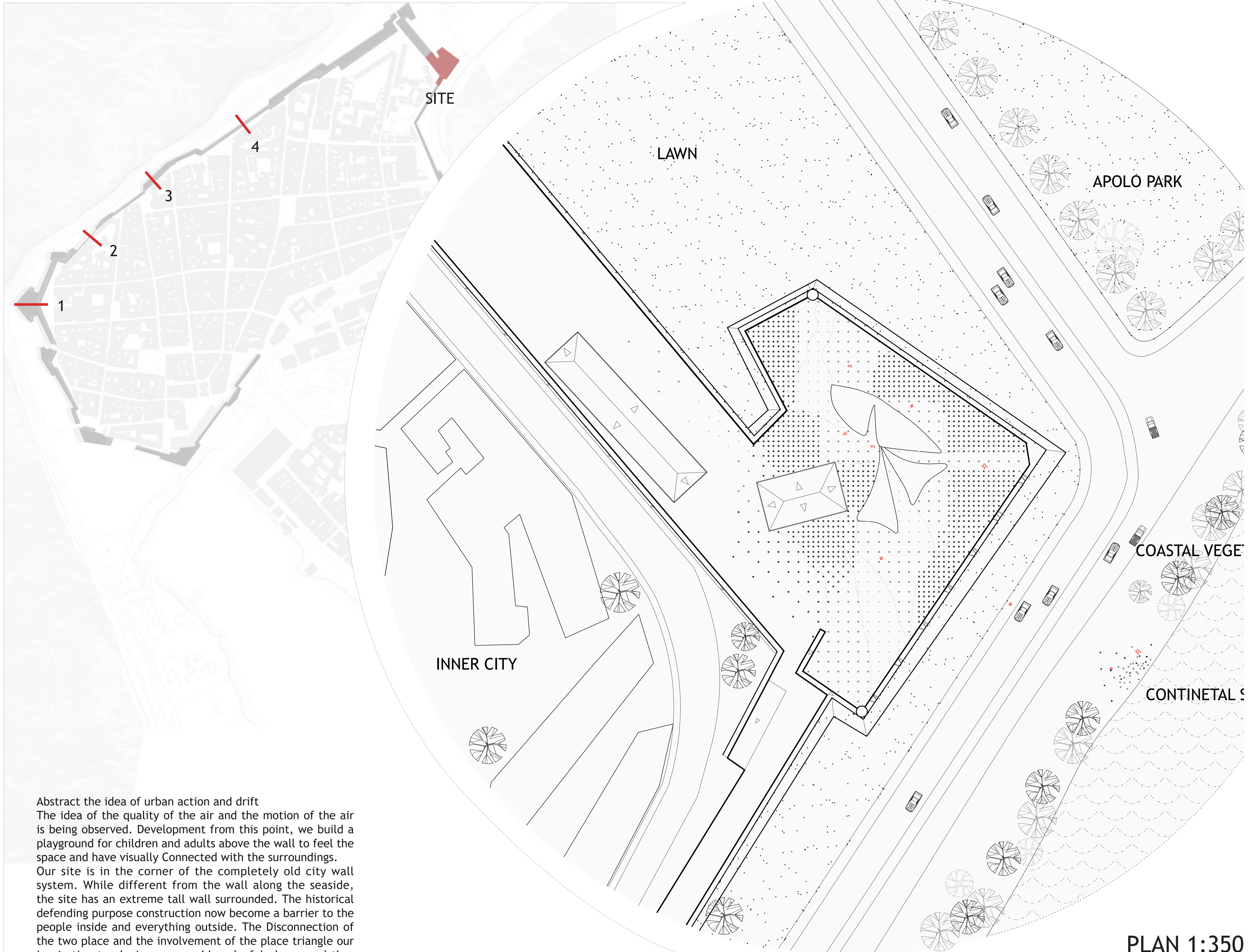

PLAN 1:350

Abstract the idea of urban action and drift. The idea of the quality of the air and the motion of the air is being observed. Development from this point, we build a playground for children and adults above the wall to feel the space and have visually Connected with the surroundings. Our site is in the corner of the completely old city wall system. While different from the wall along the seaside, the site has an extreme tall wall surrounded. The historical defending purpose construction now become a barrier to the people inside and everything outside. The Disconnection of the two place and the involvement of the place triangle our inspiration to placing a moveable, playful playground thus to surrounding surroundings.

A simple Cylinder could change the whole place. The design is located above the historical wall. We do not want to offend the wall, rather, we would like to create another layer for people to use. A movable cylinder with multi functions offered multi-possibility of the future development of the place. This cylinder, as a physical feature, can be a seat, can be a ladder, can be a platform for lying and playing; as a mechanical feature can transform the water in the air, can catching the motion of air thus creating sounds, can spray the water collected by tank, can be a streetlight at night. Physically, it adds several layers of the place, changing the connection inside and outside vertically; mechanically, it increases the air quality of the space. The composition of the cylinder is like the artificial topography over the wall.

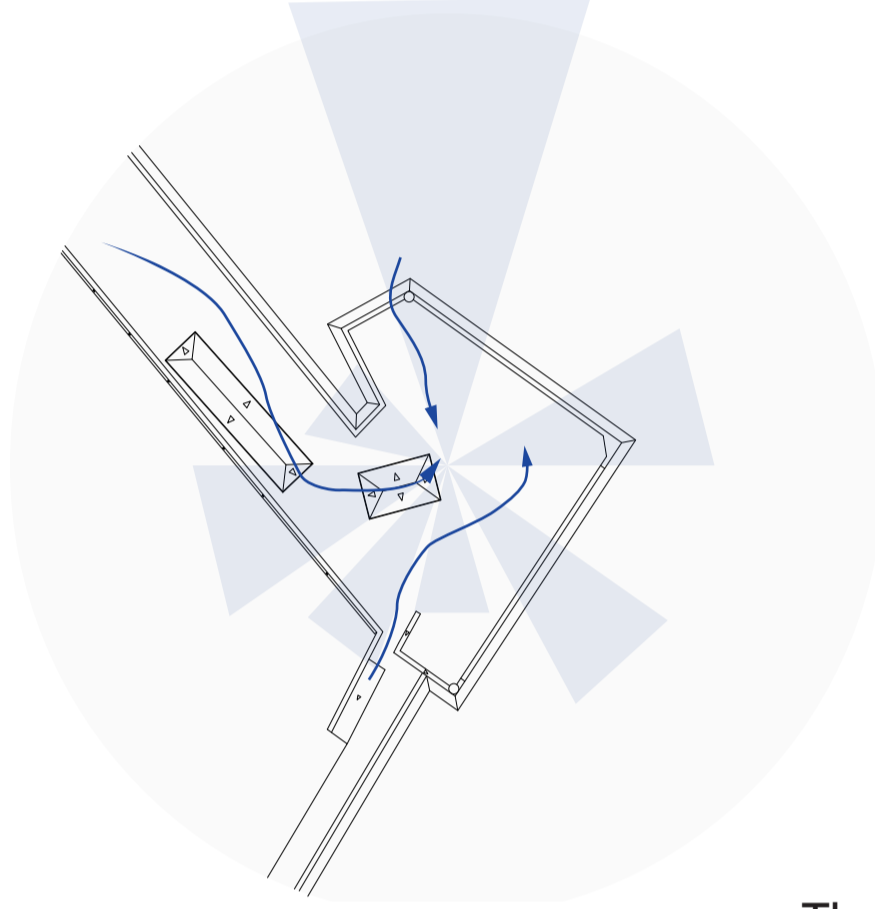
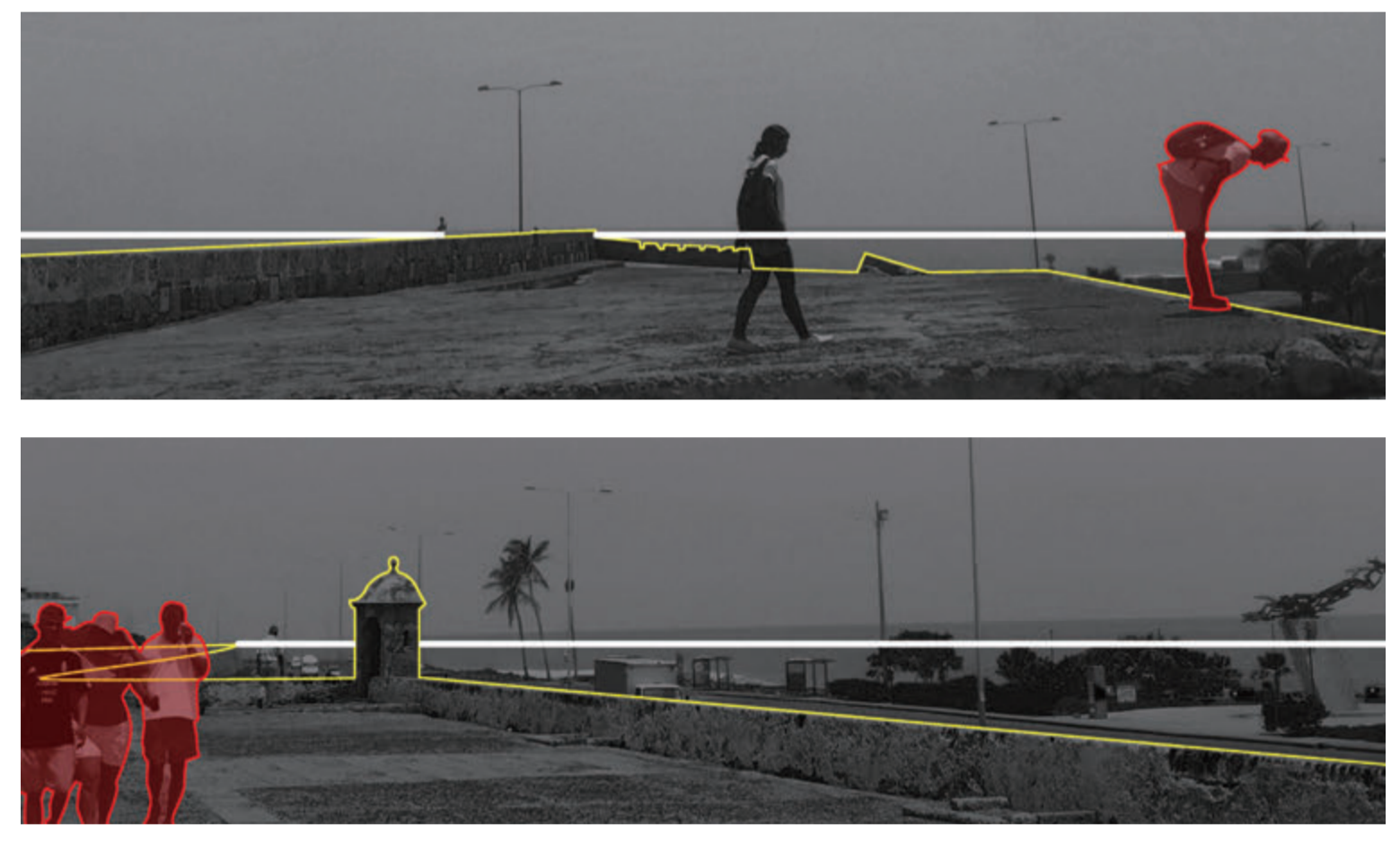
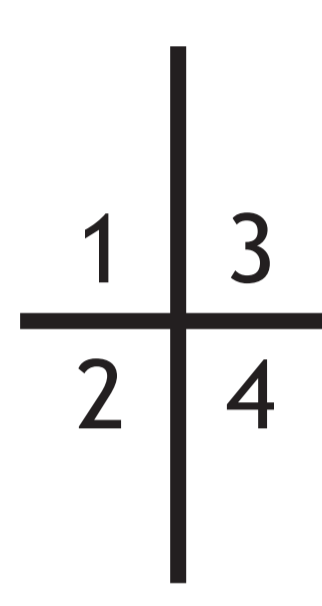

The Windrose

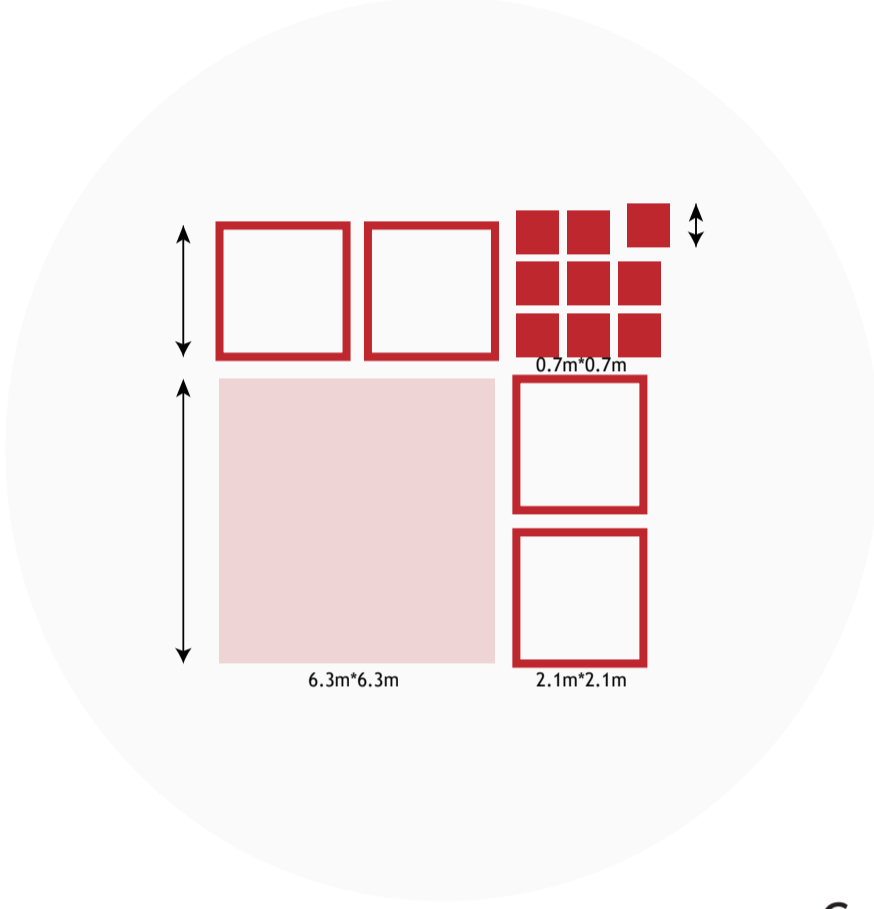

Grid System

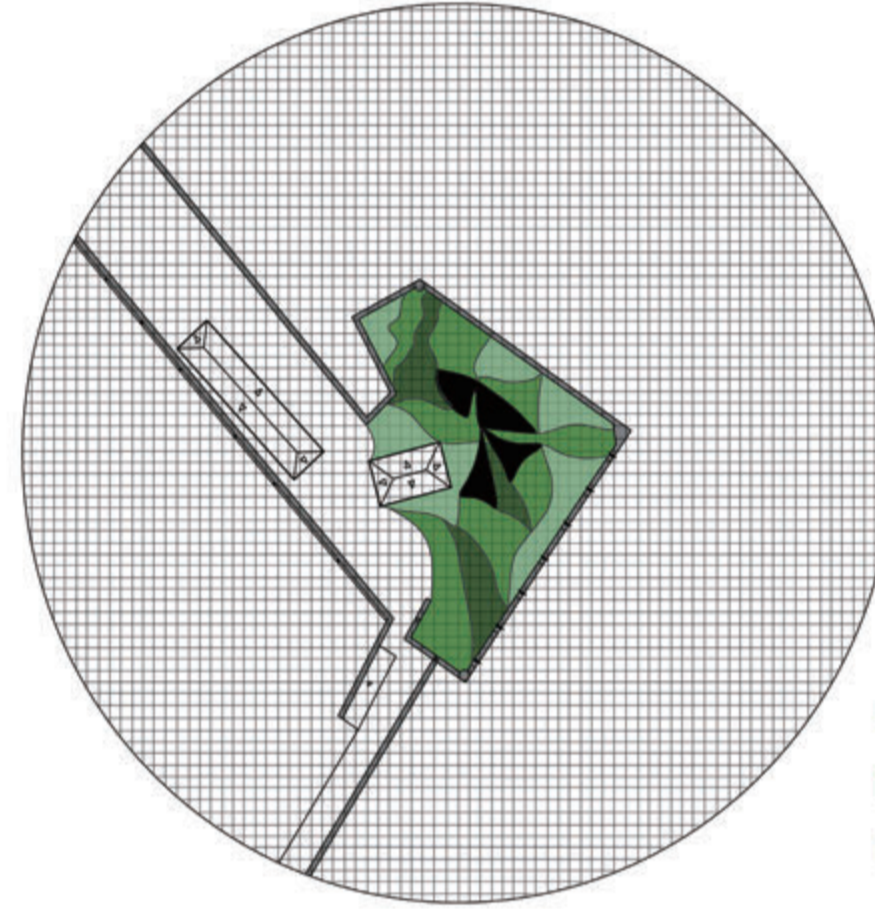

Spatial Design

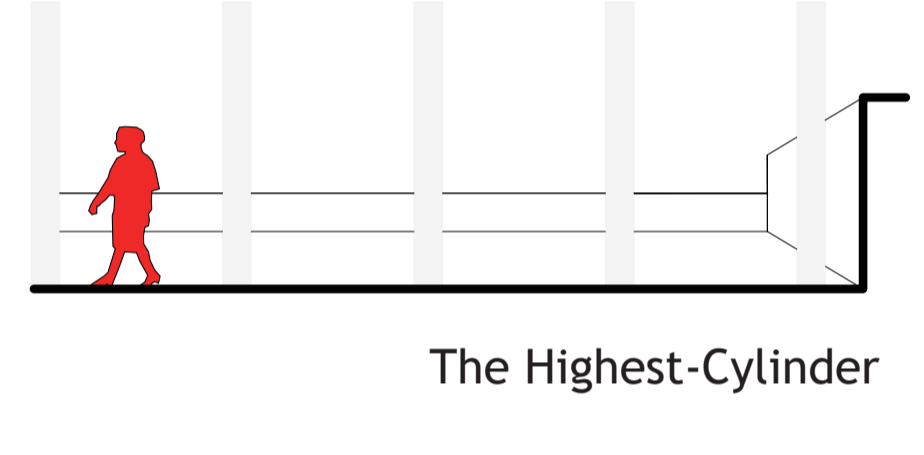

The Highest-Cylinder

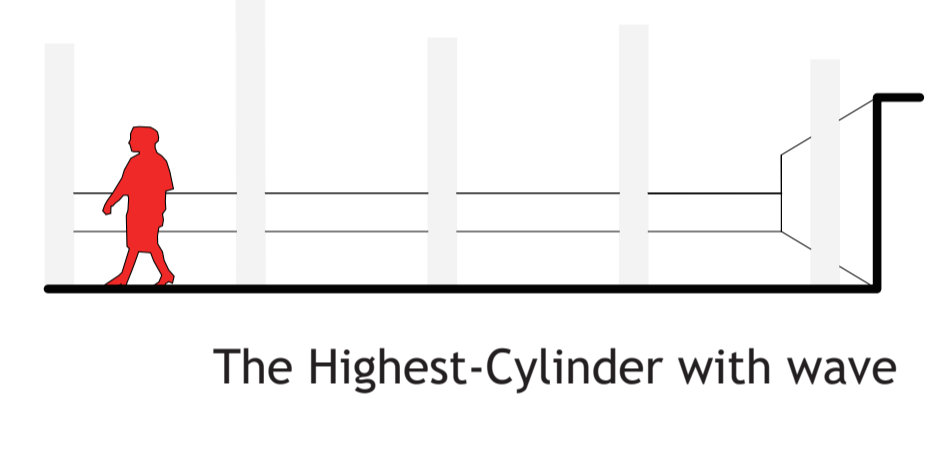

The Highest-Cylinder with wave

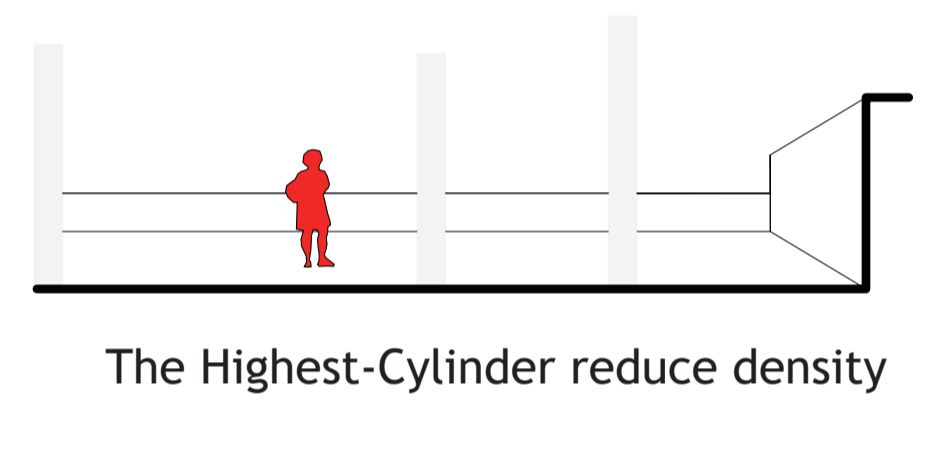

The Highest-Cylinder reduce density

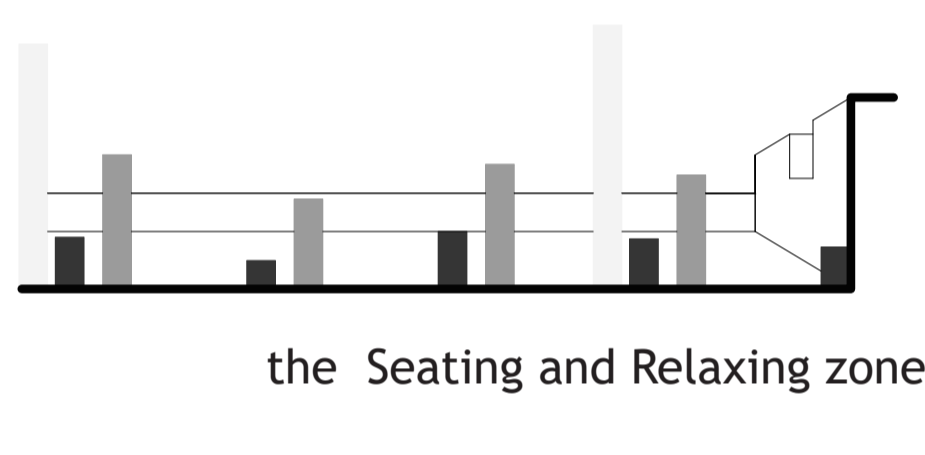

the Seating and Relaxing zone

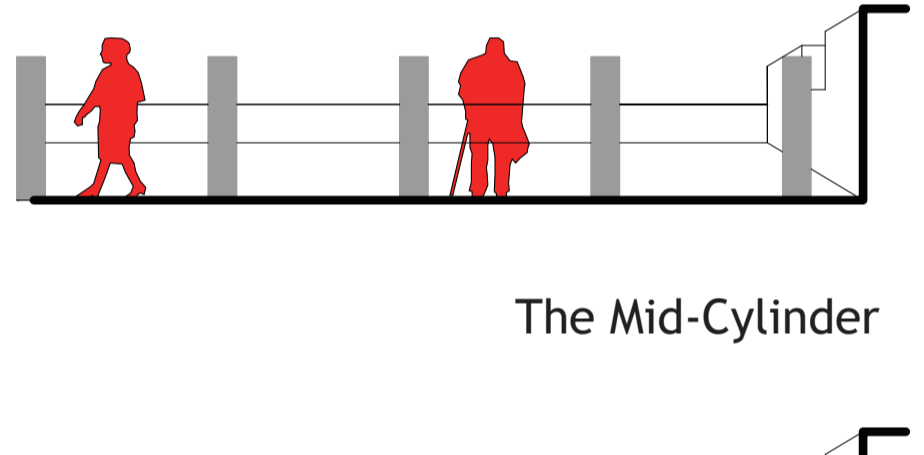

The Mid-Cylinder

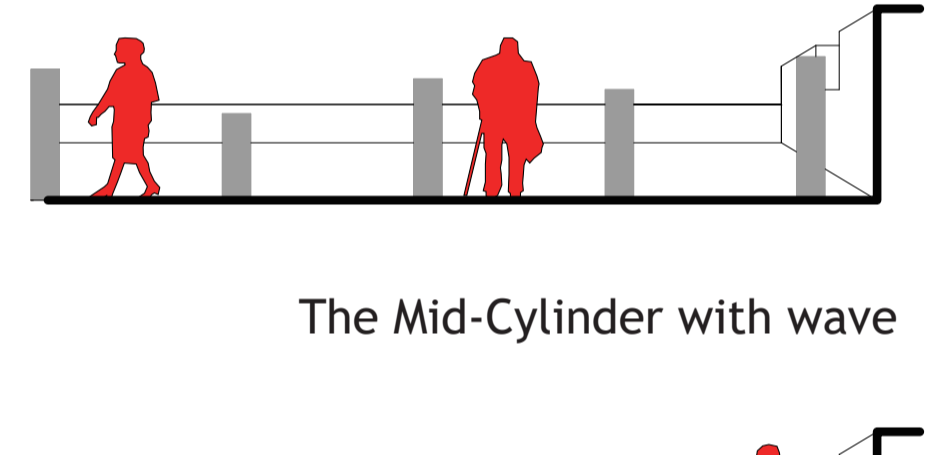

The Mid-Cylinder with wave

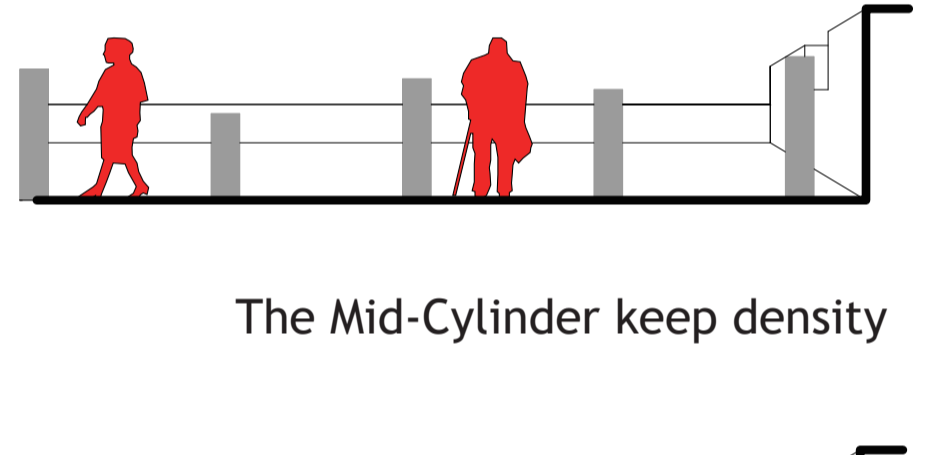

The Mid-Cylinder keep density

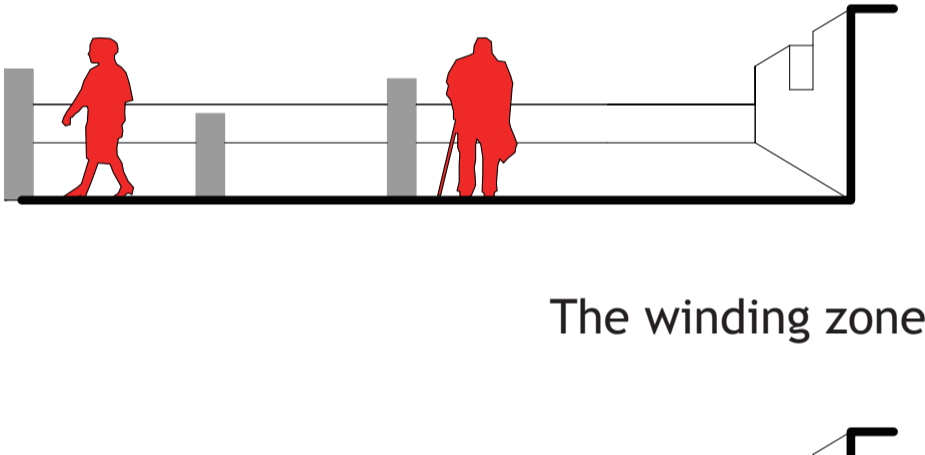

The winding zone

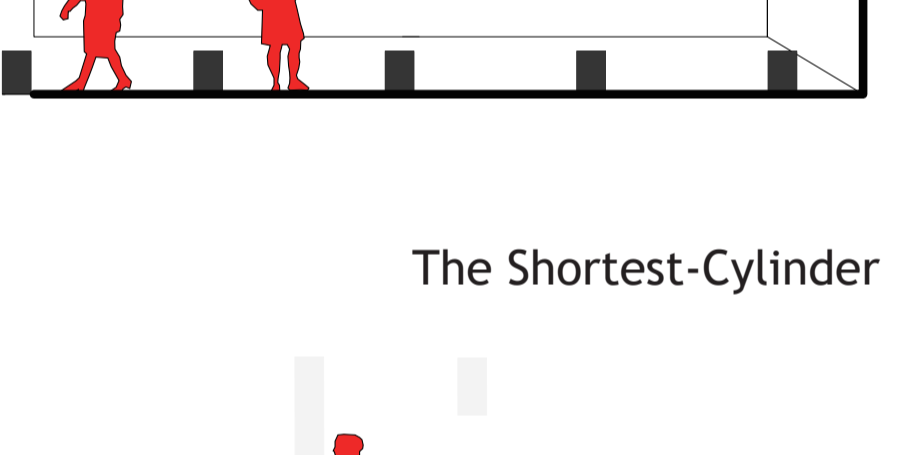

The Shortest-Cylinder

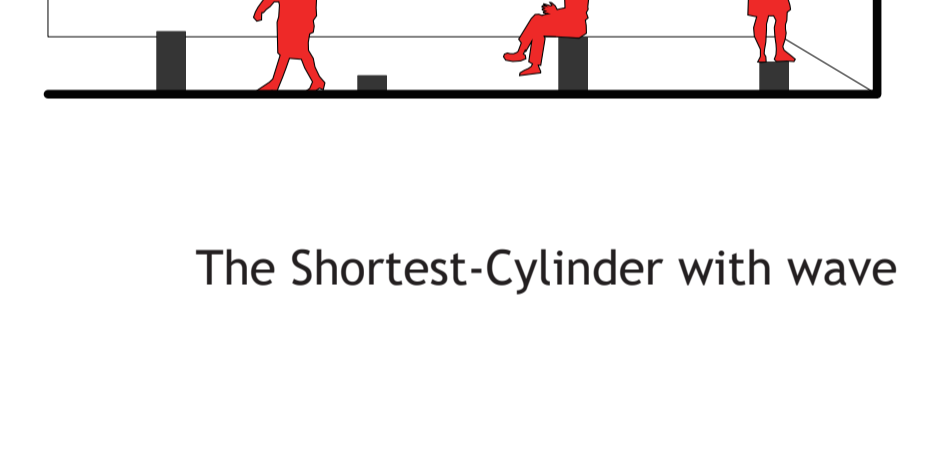

The Shortest-Cylinder with wave

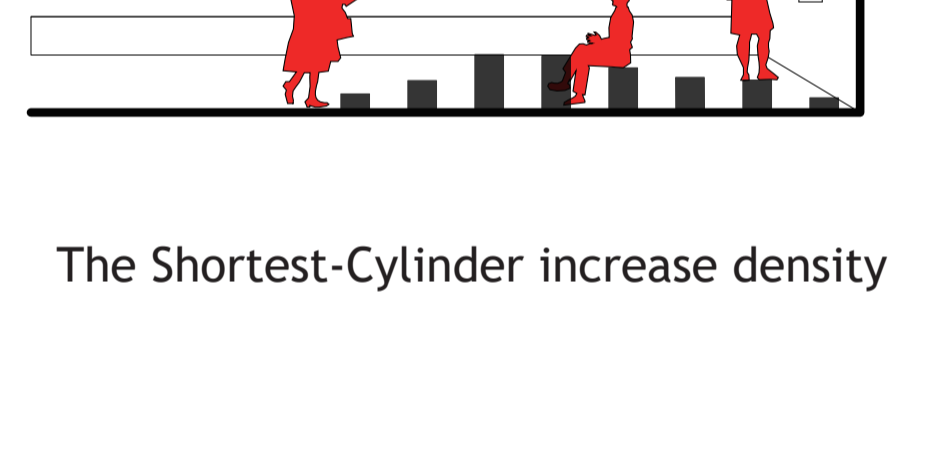

The Shortest-Cylinder increase density

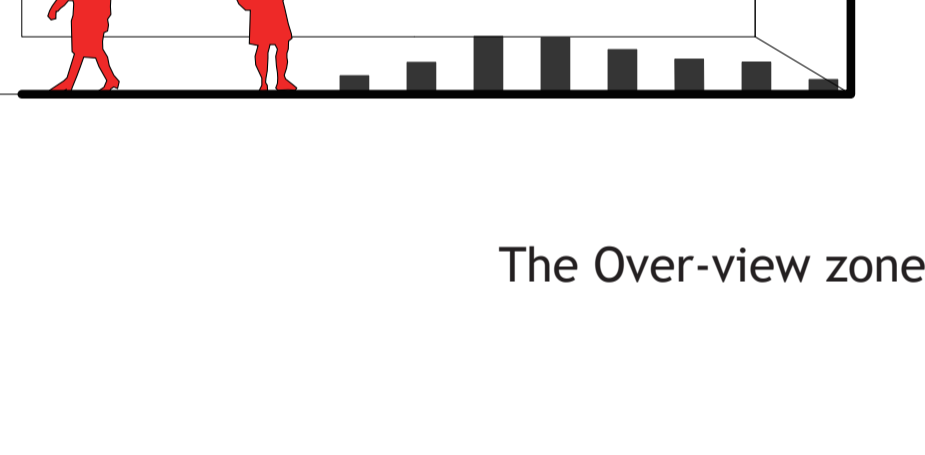

The Over-view zone

THE HIERARCHY OF CYLINDER

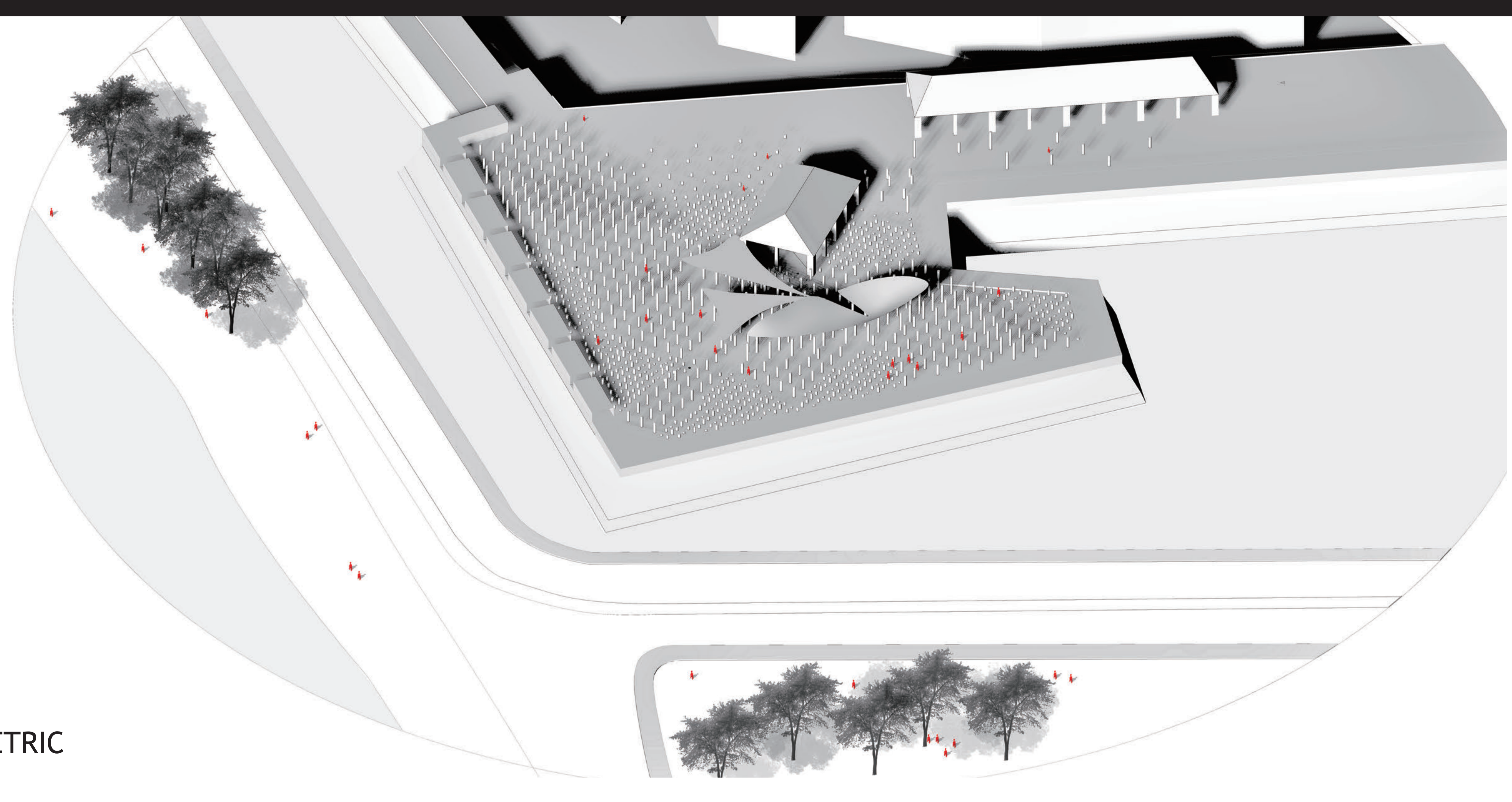

ISOMETRIC

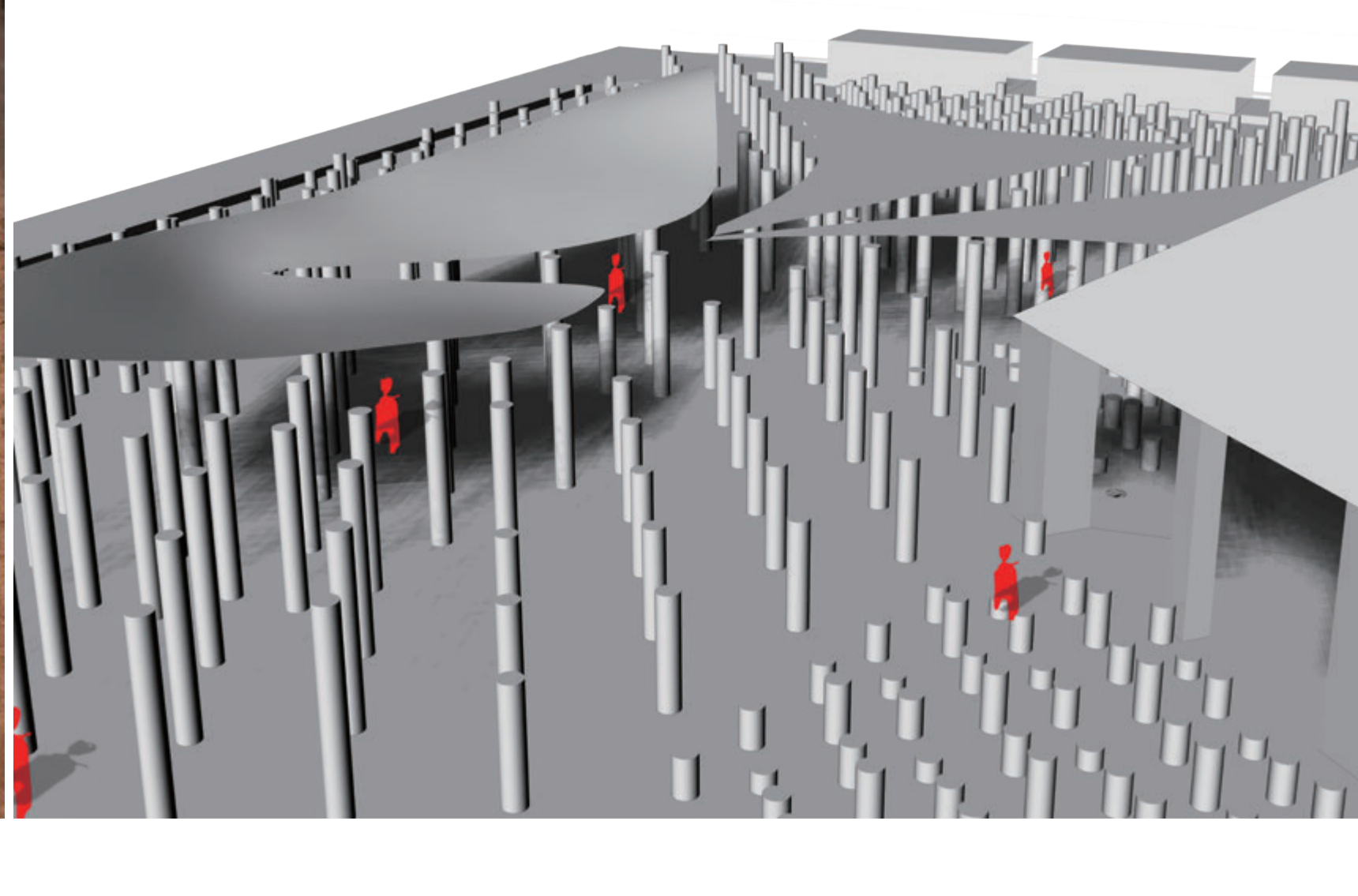
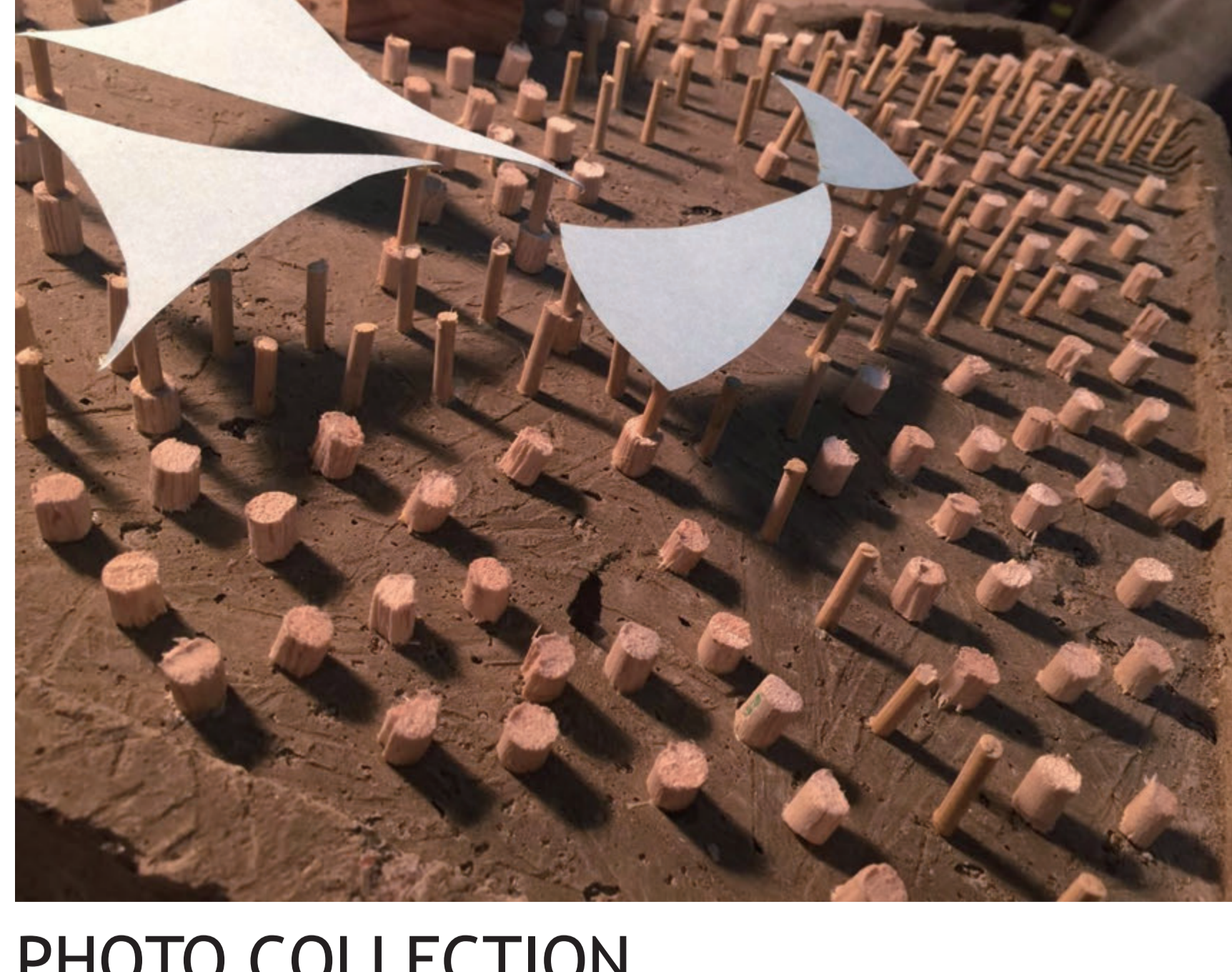
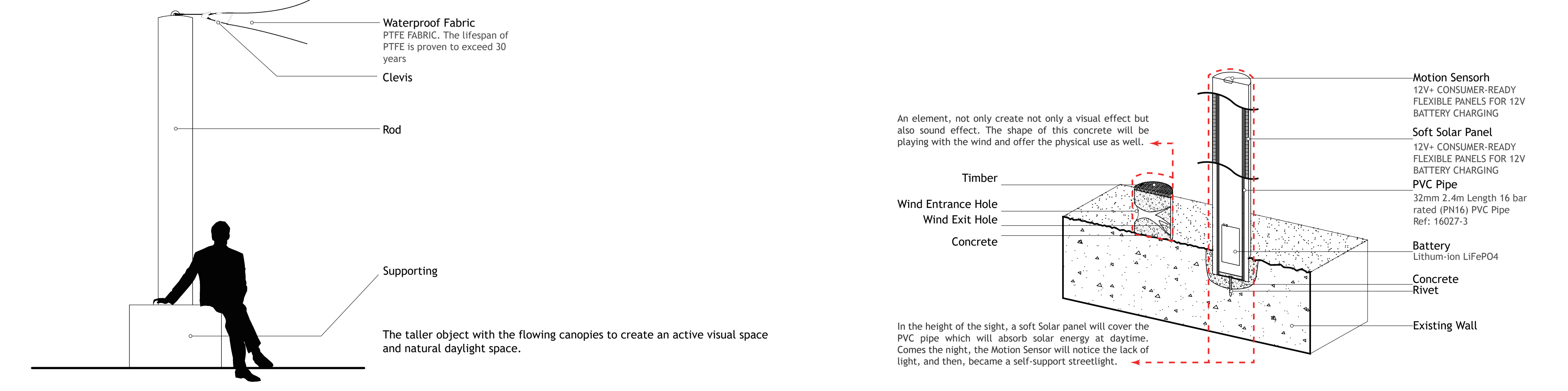

PHOTO COLLECTION



DETAIL 1:20